

DESIGNED	DRAWN	CHECKED	BY DATE
JUL	JUL	KOW	
		RYCHARGE	
		TWG	

MAINTENANCE OF TRAFFIC - DETOUR PLAN
STEARNS ROAD

PROJECT 43-23-03A
DATE: 08/06/21

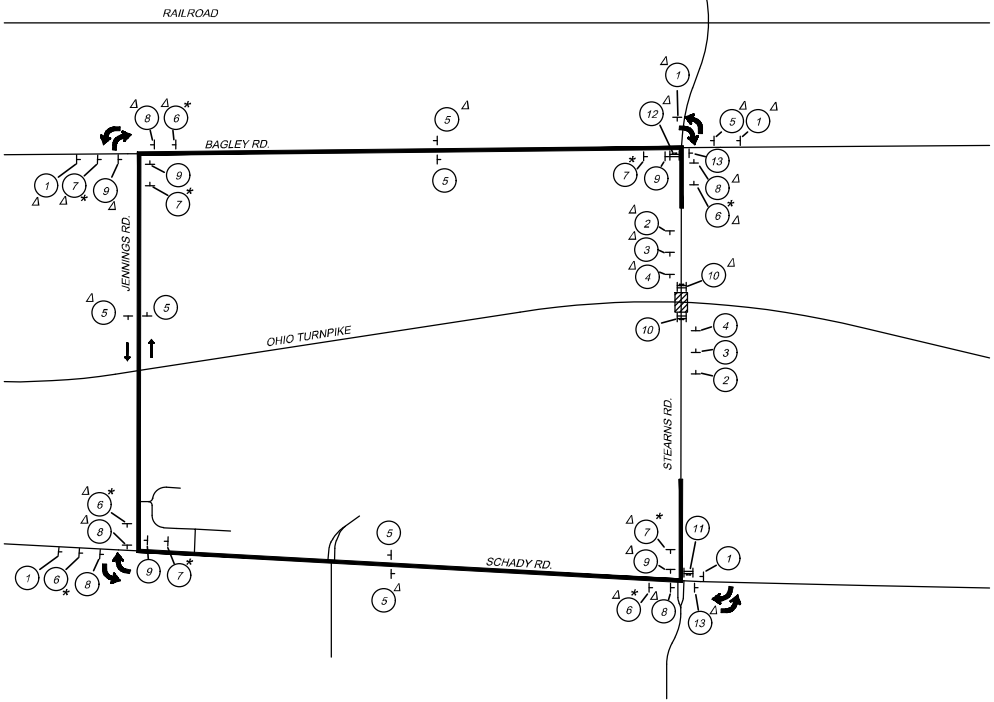

NOTES:

1. ALL TRAFFIC CONTROL DEVICES SHALL CONFORM TO THE CURRENT EDITION OF THE "OHIO MANUAL OF UNIFORM TRAFFIC CONTROL DEVICES" (OMUTCD).
2. THE CONTRACTOR SHALL FURNISH, ERECT, MAINTAIN, AND SUBSEQUENTLY REMOVE ALL BARRICADES, SIGNS, SIGN SUPPORTS, AND INCIDENTALS RELATED TO STEARNS ROAD DETOUR AS SHOWN ON THIS SHEET.
3. PAYMENT FOR ALL LABOR, EQUIPMENT, AND MATERIALS SHALL BE CONSIDERED INCIDENTAL TO SP 614 - MAINTAINING TRAFFIC UNLESS ITEMIZED SEPARATELY.
4. SIGNS MARKED WITH A DELTA (Δ) TO BE REMOVED FOR ALL PHASED CONSTRUCTION THAT EXTENDS PAST 150 DAYS. AFTER 150 DAYS, THE SOUTHBOUND MOVEMENT SHALL BE MAINTAINED, AND THE NORTHBOUND DETOUR SHALL REMAIN IN PLACE.
5. THE CONTRACTOR SHALL COVER OR REMOVE EXISTING CONFLICTING SIGNING AND/OR PAVEMENT MARKING PRIOR TO CONSTRUCTION. CONFLICTING PAVEMENT MARKINGS SHALL BE REMOVED UNLESS COVERED WITH NEW PAINT.
6. ROAD CLOSURE USING TYPE III BARRICADES, INCLUDING ADVANCE WARNING SIGNS, SHALL BE SET AS SHOWN ON ODOT STANDARD CONSTRUCTION DRAWING MT-101.60.
7. SEE SHEET 7 FOR MAINTENANCE OF TRAFFIC GENERAL NOTES AND INFORMATION.
8. SEE SHEET 7 FOR NOTICE OF CLOSURE SIGN INFORMATION.

LEGEND:

- * 500' FROM INTERSECTION
- + SIGN MOUNTED ON POST
- ⊥ SIGN MOUNTED ON TYPE III BARRICADE
- ▨ WORK AREA
- ↑ TRAFFIC FLOW
- DETOUR ROUTE
- Δ SEE NOTE 4

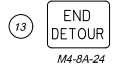
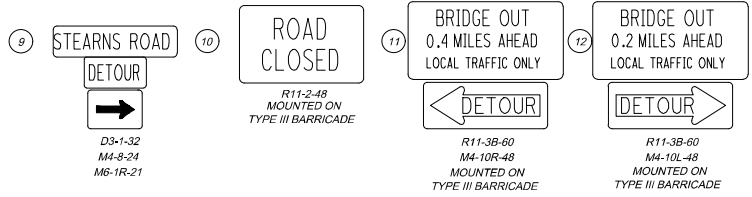
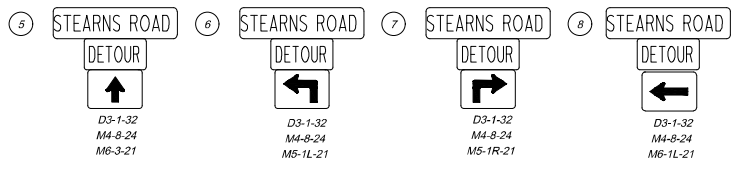
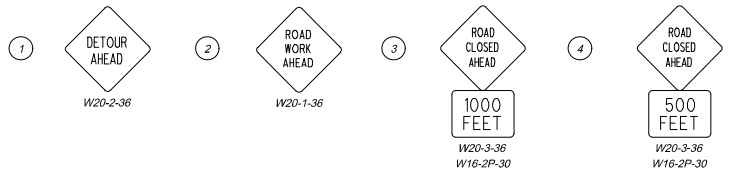

MP154-6_MTD01.dwg, 11/02/22 - 9:25am